

See PIM Shield Rail System application note for loading information

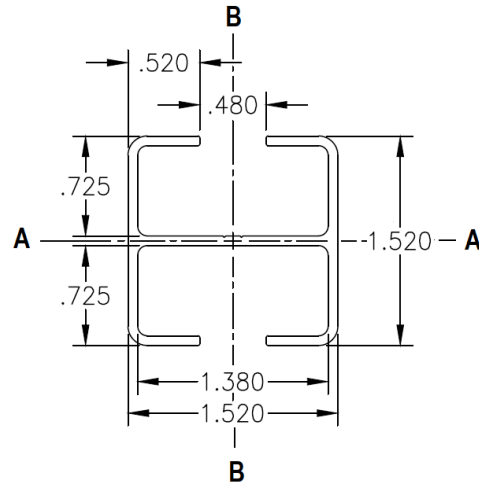

Nominal dimensions (inches)

For patents see www.cf-pat.com

SPECIFICATIONS

General	PIM Shield Cable Support Rail material is available in 6 FT lengths for custom cable support and equipment mounting frames at cell sites. Mounting brackets and channel runner hardware can be purchased separately.	
Material	6005A-T61, Extruded Aluminum	
Finish	Clear anodize	
MATERIAL PROPERTIES	TYPICAL SPECIFICATION	
Yield Strength	35 ksi. (min)	
Modulus of Elasticity	10,100 ksi.	
Poisson's Ratio	0.33	
SECTION PROPERTIES	AXIS A-A	AXIS B-B
Moment of Inertia (I)	.100 in ⁴	.152 in ⁴
Section Modulus (S)	.132 in ³	.200 in ³
Radius of Gyration (r)	.483 in	.597 in
Cross Section Area	0.427 in ²	
Length	6 FT	
Weight (each rail)	3.0 lbs.	
Case Quantity	10	
Case Weight	30.8 lbs.	
Case Dimensions	73.5-in x 8.5-in x 3.5-in	